



34 Kingsway, Scunthorpe, DN17 1BJ

£300,000

In a central location is this fantastic size two bedroom detached bungalow on Kingsway overlooking Central Park with vacant possession and no onward chain!

As you enter the property you have good room sizes throughout comprising of a spacious entrance hall, a lounge, dining room, kitchen that also has a separate seating area, utility, two double bedrooms and a bathroom.

Outside you have a rear garden mainly laid with turf with separate planting and seating areas, a double garage and off road parking for a few vehicles. Available to view now please call the office to book your appointment.



Entrance hall



Bedroom one 13'5" x 13'0" (4.11 x 3.98)



Bedroom two 13'0" x 11'8" (3.98 x 3.58)



Lounge 15'7" x 13'0" (4.75 x 3.97)



Dining room 14'1" x 13'0" (4.30 x 3.97)



Bathroom 13'0" x 5'9" (3.98 x 1.77)



Garage 19'11" x 18'0" (6.08 x 5.50)

Outside



Kitchen 13'3" x 9'9" (4.04 x 2.99)



Utility room

W.C.

Floor Plan

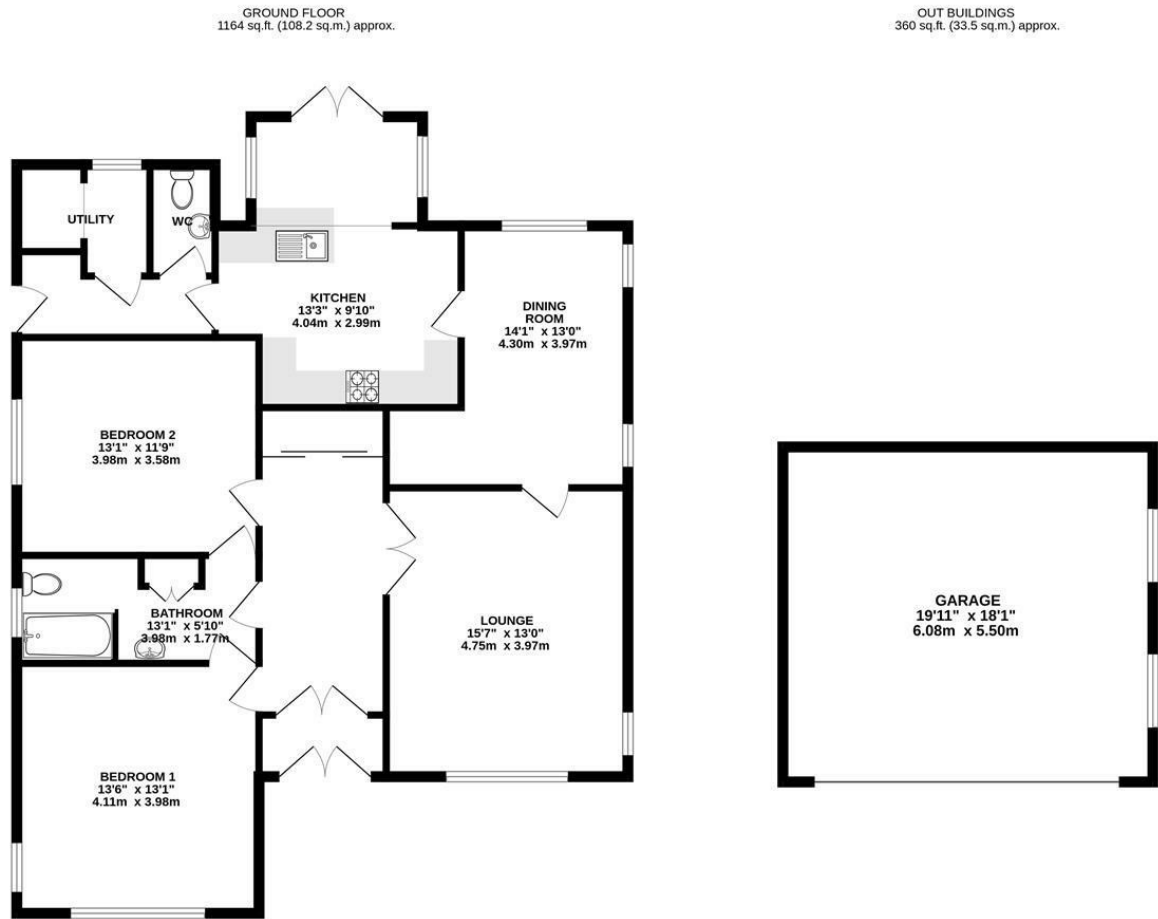

TOTAL FLOOR AREA: 1525 sq.ft. (141.6 sq.m.) approx.

Whilst every attempt has been made to ensure the accuracy of the floorplan contained here, measurements of doors, windows, rooms and any other items are approximate and no responsibility is taken for any error, omission or mis-statement. This plan is for illustrative purposes only and should be used as such by any prospective purchaser. The services, systems and appliances shown have not been tested and no guarantee as to their operability or efficiency can be given.

Made with Metropix ©2025



Area Map

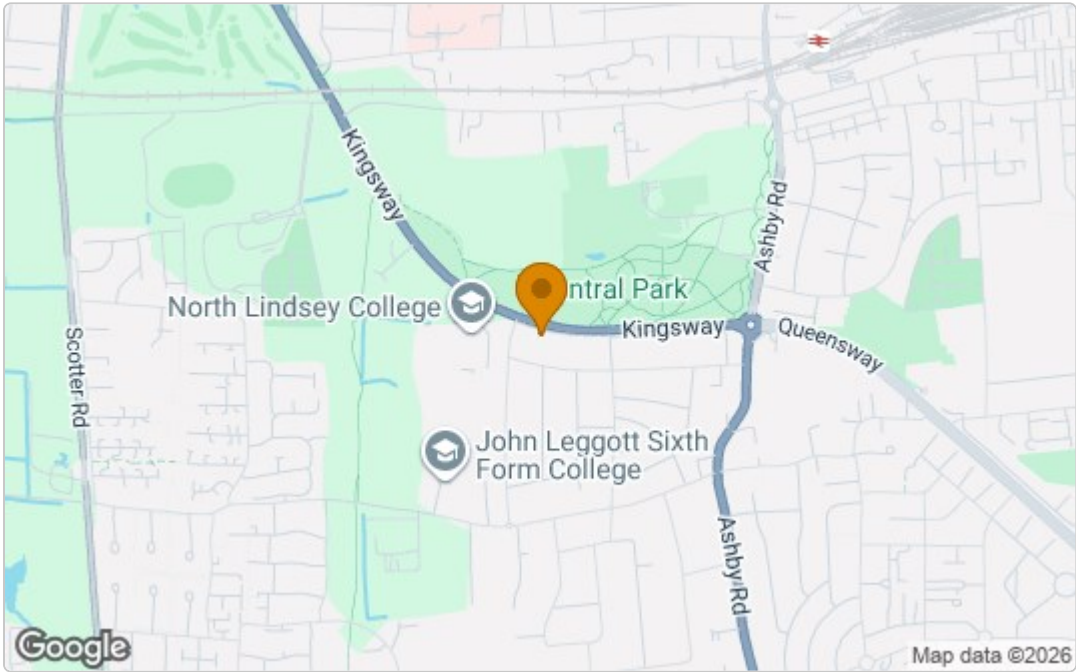

Energy Efficiency Graph

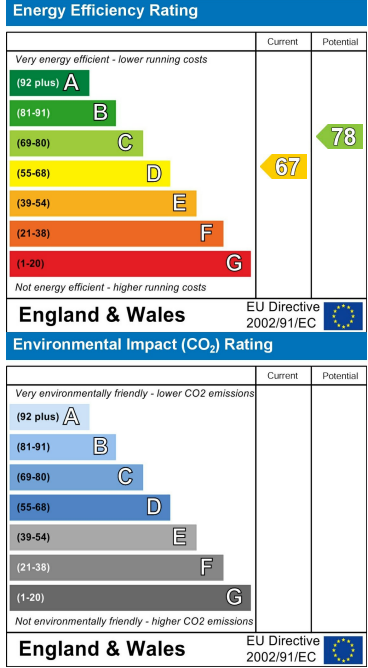

These particulars, whilst believed to be accurate are set out as a general outline only for guidance and do not constitute any part of an offer or contract. Intending purchasers should not rely on them as statements of representation of fact, but must satisfy themselves by inspection or otherwise as to their accuracy. No person in this firm's employment has the authority to make or give any representation or warranty in respect of the property.